

SSP: Technical Data

31 Sight Glasses, plastomer-lined

PM 31 M.01 e

March 2006



Operating Conditions

- Temperature range from -40°C up to $+200^{\circ}\text{C}$ (depending on lining material)
- Pressure range from 1 mbar up to 16 bar

Testing / Marking

- Pressure- and tightness testing acc. to EN 12266-1, leakage rate A, and spark testing at 35 kV to assure lining integrity. Marking of valves on body and name plate acc. to EN 19.
- Material- resp. test certificate acc. to EN 10204-3.1

Pressure-/Temperature Diagram

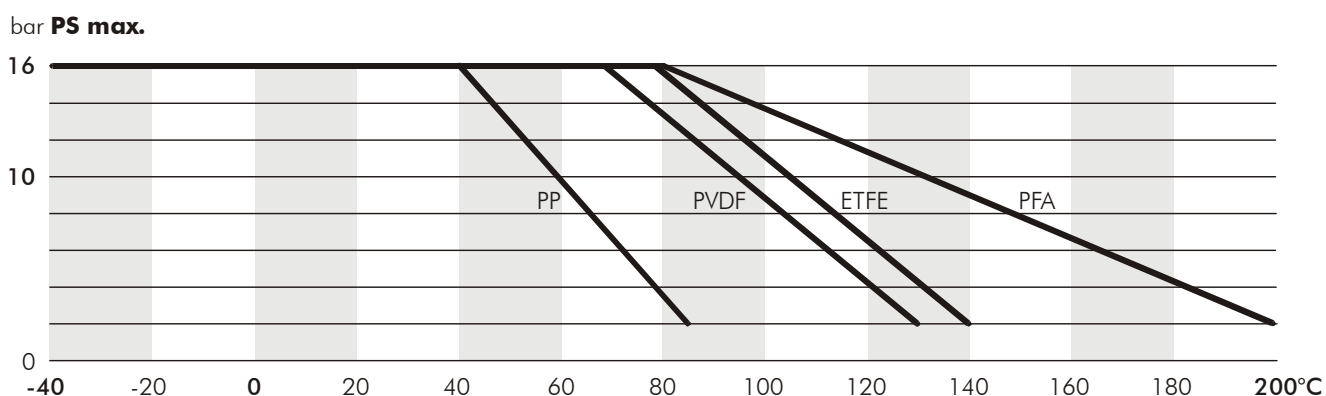

Technical Data

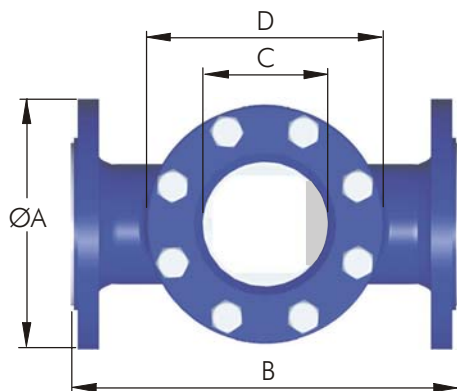

Standard Materials of Components

Body	Cast Steel 1.0619 (WCB) epoxy-coated
Flange	Cast Steel 1.0619 (WCB) epoxy-coated
Lining	PFA
Glass Plate	Borosilicate 8488 acc. to DIN 7080
Gasket	C-4400 asbestos-free
Bolts	A2-70 SS304

Dimensions in mm

DN	15/1/2"	20/3/4"	25/1"	40/1/2"	50/2"	65/2 1/2"	80/3"	100/4"	150/6"
ØA DIN	95	105	115	150	165	185	200	220	285
ØA ANSI	95	105	108	127	152	178	190	229	279
B DIN	130	150	160	200	230	290	310	350	480
B ANSI	130	150	152	178	203	290	310	350	480
ØC	33	33	48	65	80	80	100	125	200
D	□70	□70	□85	□110	□120	Ø175	Ø190	Ø210	Ø290
ØGlass	45x10	45x10	63x10	80x12	100x15	100x15	125x20	150x25	225x30
kg appr.	2.8	3.6	4.1	6.8	10.1	16.4	19.0	37.2	46.8

Face to face B acc. to DIN EN 558-1 range 1 resp. ASME B16.10, other sizes upon request